

lenovo

Lenovo A6000

Quick Start Guide v1.0

 Read this guide carefully before using your smartphone.

Technical specifications



Model and system

Model: Lenovo A6000

System: Android



Dimensions and weight

Height: 140.9 mm (5.547 inches)

Width: 70.55 mm (2.778 inches)

Depth: 8.2 mm (0.323 inch)

Weight: 129.6 g (0.286 lb)



Processor

Processor: Qualcomm MSM8916, Quad Core, 1.2 GHz



Camera

Type: CMOS

Pixels: 8.0 megapixels (back) + 2.0 megapixels (front)



Battery

Battery: 2300 mAh



Display

Size: 5.0 inches

Screen: multi-touch

Resolution: 1280 × 720 pixels

LCD type: IPS



Wireless Communication

Bluetooth 4.0; WLAN 802.11 b/g/n; ^②LTE, WCDMA, GSM; GPS



- ① Depending on the measuring method, the dimensions and weight might vary slightly.
- ② In some countries, LTE is not supported. To know if your smartphone works with LTE networks in your country, contact your carrier.

First glance

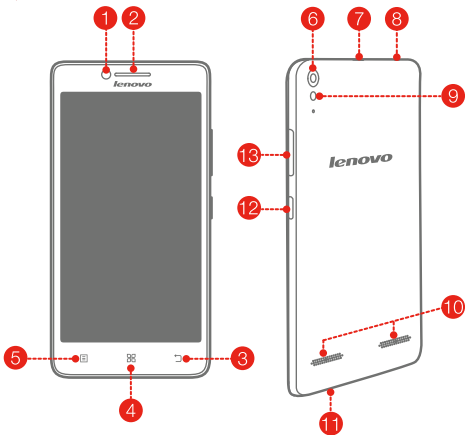

1 Front-facing camera

2 Receiver

3 Back key

4 Home key

5 Menu key

6 Rear-facing camera

7 Micro USB connector

8 Headset connector

9 Flashlight

10 Speaker

11 Microphone

12 On/Off button

13 Volume buttons

Preparing your smartphone

You must insert the SIM card provided by your carrier to use cellular services. Set up your smartphone as shown.

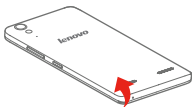

Step 1. Open the back cover.

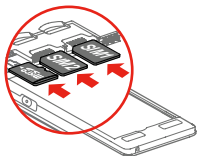

Step 2. Insert the SIM cards and the memory card.

Tip: Insert the (U)SIM card into SIM1 slot and SIM card into SIM2 slot.

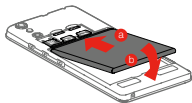

Step 3. Install the battery.

- a. Align the battery connectors on the battery with the pins in the battery compartment.
- b. Push the battery down into place.

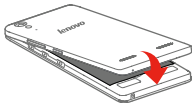

Step 4. Install the back cover.

Always turn off your smartphone first before you insert or remove a SIM card. Insert or remove a SIM card with your smartphone on may damage your SIM card or smartphone permanently.

Charging the battery

Charge the battery as shown.

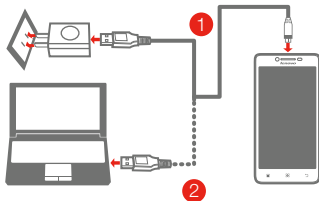

Method 1. Connect your smartphone to a power outlet using the cable and USB power adapter that come with your smartphone.

Method 2. Connect your smartphone to a computer using the cable that comes with your smartphone.

 Low battery power  Fully charged  Charging

Turning on or turning off your smartphone

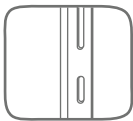

Turn on: Press and hold the On/Off button until the Lenovo logo appears.

Turn off: Press and hold the On/Off button for a few seconds, then tap **Power off**.

Reboot: Press and hold the On/Off button for a few seconds, then tap **Reboot**.

 Your smartphone has a rechargeable battery. For more information about battery safety, see the “Rechargeable battery notice” in the *Important Product Information Guide* shipped with your smartphone.

Learning more

To learn more information about your Lenovo smartphone and obtain the latest smartphone manuals, go to:
<http://support.lenovo.com/>.

Getting support

For support on network service and billing, contact your wireless network operator. For instructions on how to use your device, go to: <http://support.lenovo.com/>.

European Union conformity



Radio and Telecommunications Terminal Equipment Directive

This product is in compliance with the essential requirements and other relevant provisions of the Radio and Telecommunications Terminal Equipment Directive, 1999/5/EC.

Legal notices

Lenovo and the Lenovo logo are trademarks of Lenovo in the United States, other countries, or both.

Other company, product, or service names may be trademarks or service marks of others.

*Manufactured under license from Dolby Laboratories. Dolby and the double-D symbol are trademarks of Dolby Laboratories.

First Edition (January 2015) © Copyright Lenovo 2015.

Reduce | Reuse | Recycle



711608000391

Printed in China